

07.3–215 Removal and installation of injection valves

Tightening torques (reference values)

Nm

Injection lines to fuel distributor

10–12

Injection lines to injection valves

10–15

Removal

- 1 Remove air filter.
- 2 Unscrew injection lines on injection valves and on fuel distributor. Apply counterhold to injection valves when loosening injection lines.

Attention!

When unscrewing injection line of cylinder 2, avoid kinks in Tecalan line (if installed), unscrew Tecalan line, if required.

- 3 Unscrew fuel line for cold-starting valve.

- 4 Loosen fastening screws and remove fastening bridges. When loosening 8th injection valve, unscrew bearing bracket for longitudinal regulating shaft, if required.

Attention!

When removing fastening bridges, apply counterhold to injection valves, so that the injection valves and the insulating sleeves are not following along.

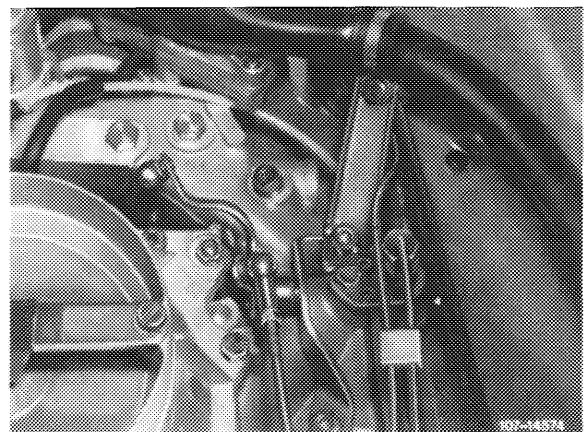

- 5 Pull out injection valves. While applying counterhold to insulating sleeve (2). If the insulating sleeves are pulled out, install new O-rings (1).

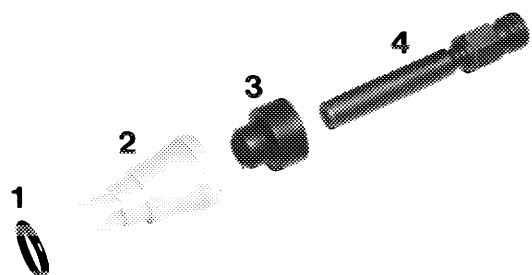

Installation

6 Install injection valves in vice versa sequence. For this purpose, displace or renew rubber sealing rings (3).

Note: Mount pulled out insulating sleeves with new O-rings.

7 Connect injection lines and fuel line for cold-starting valve while paying attention to tightening torques as reference values.

Attention!
Apply counterhold to injection valves when tightening injection lines.

8 Keep engine running and check all fuel connections for leaks.

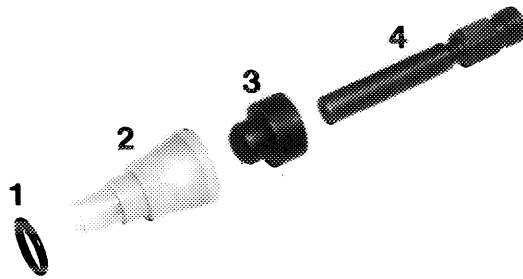

107-11773

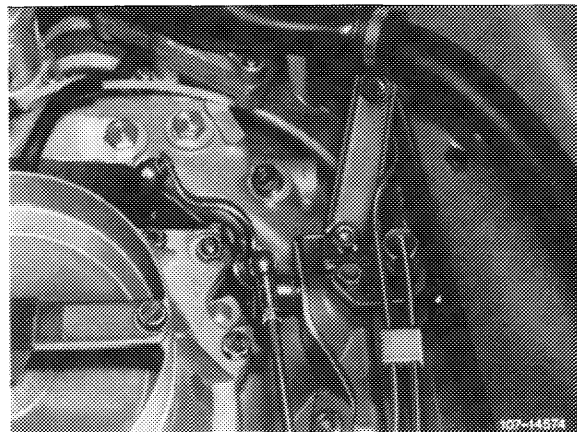

107-14675