

32–320 Removal and installation of torsion bar on rear axle (diagonal swing axle with starting torque compensation)

Data

Torsion bar Part no	Diameter	Rubber mount of torsion bar bearing Part no.	Bore dia.
116 326 23 65	18 ± 0.3	116 326 07 81	16.5

Tightening torques

	Nm	(kpm)
Hex bolts of torsion bar bearing on frame floor	70	(7)
Necked-down bolt of wheel carrier on torsion bar	80	(8)

Removal

- 1 On vehicles with level control, separate connecting rod (7) for level control from lever (6) on torsion bar.
- 2 Lift vehicle and remove righthand rear wheel.
- 3 Remove rubber rings of rear exhaust suspension. Slightly lower exhaust line and support.
- 4 Unscrew necked-down bolts of wheel carrier support left and right.
- 5 Unscrew hex screws of holding brackets of torsion bar bearing right and left.
- 6 Remove torsion bar toward the right.

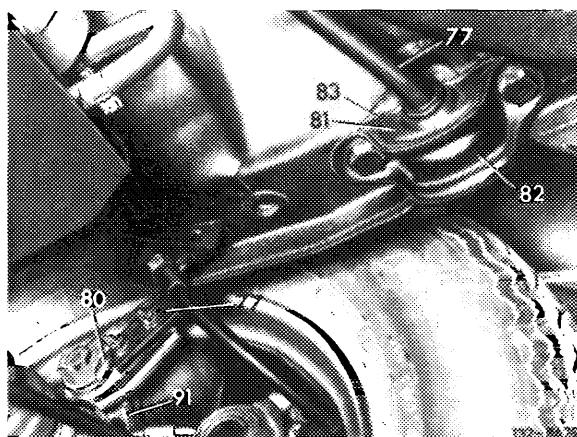
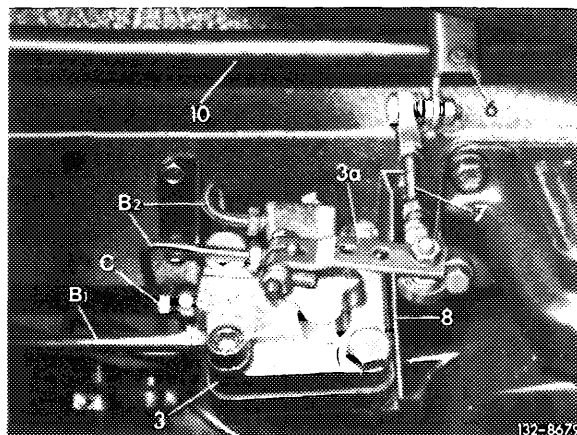

- 77 Torsion bar
- 80 Wheel carrier support on torsion bar
- 81 Rubber mount
- 82 Lower holding bracket
- 83 Upper holding bracket
- 91 Wheel carrier

Installation

- 7 Check rubber mount of torsion bar bearing and rubber mount of wheel carrier support on torsion bar.
- 8 Check threads for necked-down bolts in wheel carrier for easy operation and refinish, if required.
- 9 If required, mount lever for actuating level control to torsion bar.
- 10 Introduce torsion bar. Slip rubber mount with separating slot on top of torsion bar.
- 11 Attach torsion bar to frame floor, while making sure of correct position of upper and lower holding bracket.
- 12 Mount exhaust line and righthand rear wheel.

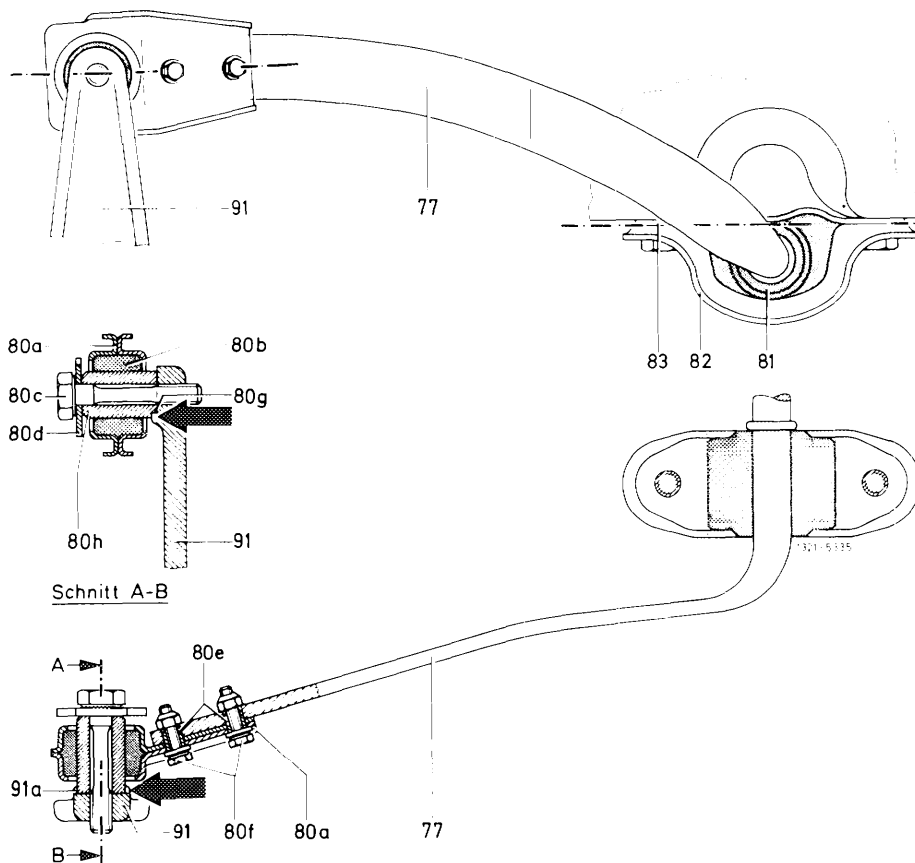

77 Torsion bar
 80a Link
 80b Rubber mount
 80c Necked-down bolt
 80d Washer
 80e Clamping sleeves
 80f Hex screws with washers and self-locking nuts
 80g Flat surface on inner bushing of rubber mount

80h Inner bushing of rubber mount
 81 Rubber mount for torsion bar bearing on frame floor
 82 Lower holding bracket
 83 Upper holding bracket
 91 Wheel carrier
 91a Flat surface on wheel carrier (on vehicles up to approx. December 1974 only)

13 Lower vehicle rear end – if required by loading trunk – until flat surface of inner bushing of rubber mount (80g) in link plate of torsion bar is in alignment with flat surface of wheel carrier (91a).

Note: On vehicles without flat surface on wheel carrier (starting approx. January 1975) tighten necked-down bolt of wheel carrier support on torsion bar only, if the vehicle is on its wheels ready for driving.

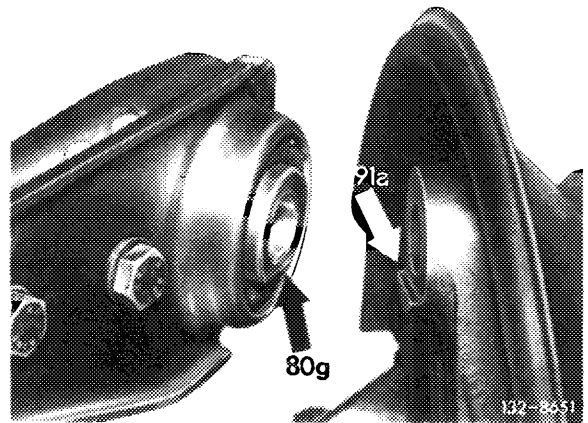

14 Connect torsion bar support with wheel carrier.

Attention!

Bearing surfaces must be absolutely clean and free of grease. When tightening, make sure of correct seat of inner bushing of rubber mounting on wheel carrier.

15 Additionally required on vehicles with level control:

a) Attach connecting rod to lever of torsion bar.

b) Check vehicle level and correct, if required (40-310)